

RETAIL AND OFFICE
SPACE FOR LEASE

ONLY 2 SPACES LEFT!

RIVERSIDE PLAZA SHOPPING CENTER



2851 RIVERSIDE PLAZA
STEAMBOAT SPRINGS, CO 80487

FEATURES

Available immediately.

Convenient access to Steamboat II and growing neighborhoods in West Steamboat.

East and west-facing Highway 40 signage. Daily commuters from Hayden, Milner and Craig.

Located amongst entertainment options, including Snow Bowl, Axe Throwing, restaurants, and more!

Close to Elk River Road and 5 minutes from downtown Steamboat.

DEMOGRAPHICS (2022)



POPULATION

1 MILE:	1,118
3 MILES:	7,305
5 MILES:	14,282



HOUSEHOLDS

1 MIILE:	415
3 MILES:	2,831
5 MILES:	5,887



HOUSEHOLD
INCOME
(MEDIAN)

1 MIILE:	\$91,999
3 MILES:	\$93,866
5 MILES:	\$95,568

LEASING INFORMATION

ASKING RATES

Call for details.

2023 EST. NNN

\$4.00/ sq. ft.

TERMS

3-5 year leases.

MAXIMUM CONTIGUOUS

2,999 sq. ft.

MINIMUM SF

1,718 sq. ft.

WESTERN CENTERS
10555 E. DARTMOUTH AVE. SUITE 360
AURORA, CO 80014



970.527.120
LEASING@WESTERNCENTERS.COM
WWW.WESTERNCENTERS.COM

**RETAIL AND OFFICE
SPACE FOR LEASE**

RIVERSIDE PLAZA



SUITE	TENANT	SQ. FT.
100	Steamboat II Metro. District	920
110	Enterprise Rent-A-Car	1,800
120	AVAILABLE*	2,079
130	Christy Sports	11,148
190	Steamboat Axe Throwing at The Timber	3,152
200	Yampa Valley Chiropractic	1,178
210-A	Snow Bowl Office	517
210-B, 230	Colorado Bagel Company	2,799
220	AVAILABLE	1,718
240,250	Four Points Physical Therapy	2,435
250-A	Yampa Valley Recycles Depot	641
260	Christ for Life Ministries/ Sk8 Church	4,827

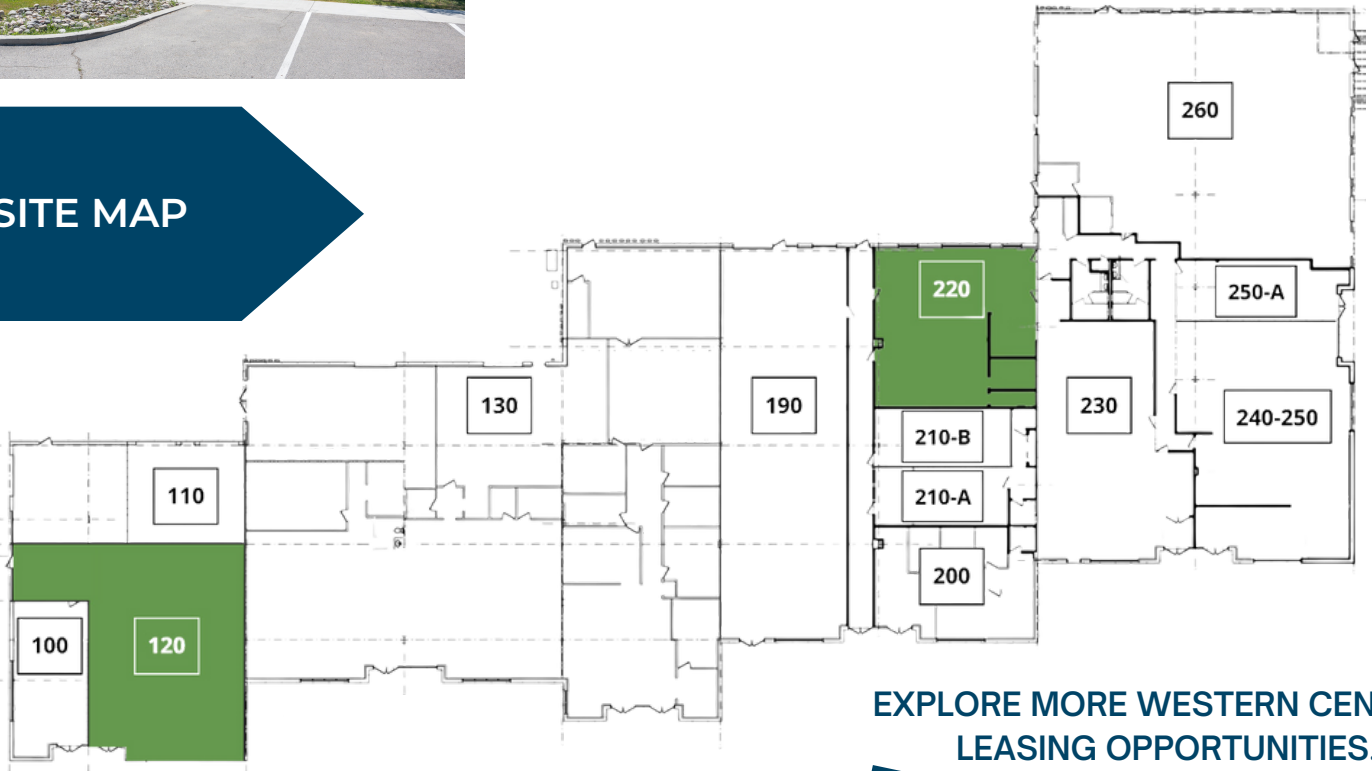

**EXPLORE MORE WESTERN CENTERS
LEASING OPPORTUNITIES.**

JOIN THESE GREAT TENANTS!



WESTERN CENTERS
10555 E. DARTMOUTH AVE. SUITE 360
AURORA, CO 80014



970.527.1200
LEASING@WESTERNCENTERS.COM
WWW.WESTERNCENTERS.COM